

Installation instructions

ModuLink 250 RF - Single channel modulating programmable room thermostat

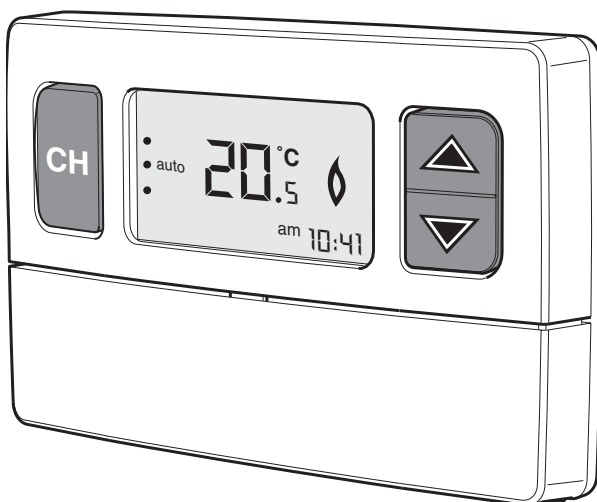

24 Volt only

Buderus

**Please read thoroughly before operating the unit
See boiler installation instructions for more details**

Installation, maintenance and repair must be carried out by a competent person (e.g. Corgi Registered) and in accordance with current IEE wiring regulations.

The single channel ModuLink can be fitted on all Boulter Buderus or Buderus appliances with an external control unit from the following types: UBA1.5, UBA3.0 and DBA.

1 Contents of package

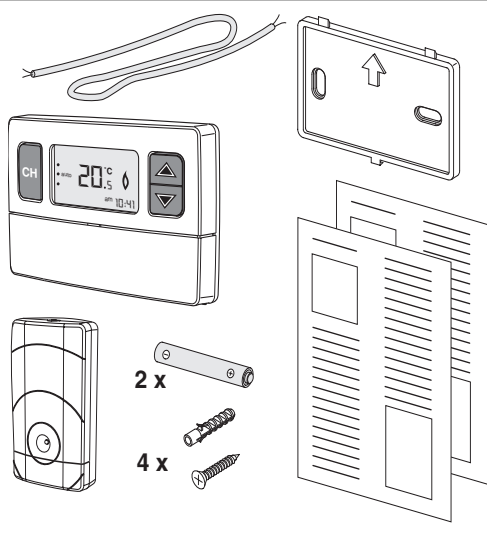

2 Installing the receiver

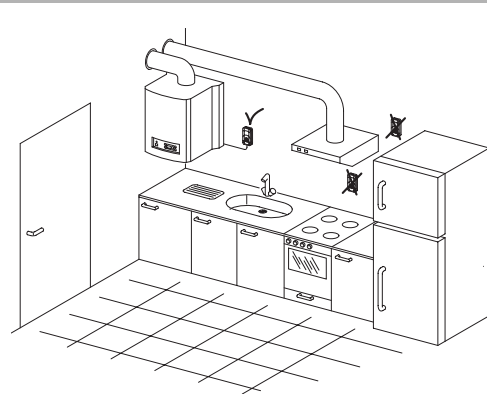

Find a suitable place for the receiver.
For best performance an open space is best.
Leave at least 30 cm distance from any metal objects including wall boxes and the boiler.

3

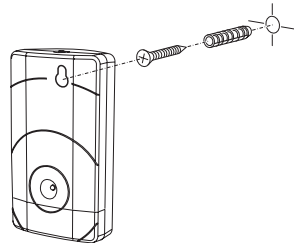

Drill a hole, insert the plug and mount screw.
Place receiver over the mounted screw.

4

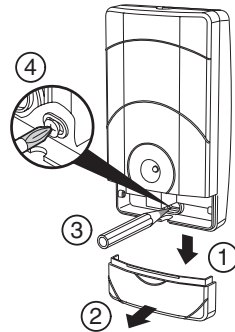

Open the lid of the receiver (1 and 2). Mark the hole (3) for the second screw with a pencil.
Remove the receiver, then drill a hole for the plug.
Refit the receiver and mount the screw (4).

5

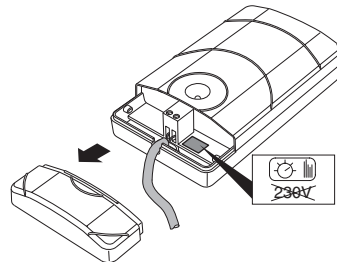

Attach cable (not thicker than 2.5 mm²) to the receiver. The wires are not polarity sensitive.
Attach the cable to the boiler. See installation and servicing instructions of the boiler for more information.

Warning! DO NOT connect the cable to 230V.
When installed correctly a green LED appears on the receiver.

6 Installing the room thermostat

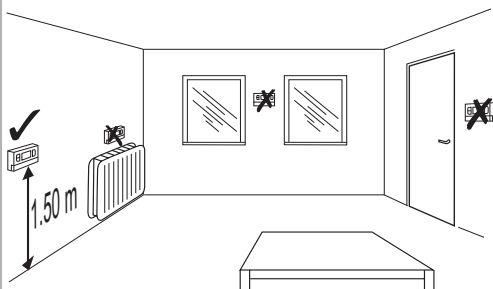

The room thermostat should be installed in:

- in an open space
- near the main living area
- on an inside wall
- away from light and heat source
- away from RF interference
- away from direct draughts
- away from damp and condensate
- away from large metal surfaces
- at least 1m away from electrical equipment.

Due to the building regulations the thermostat should not be placed in an area with TRV (temperature radiator valves).

7

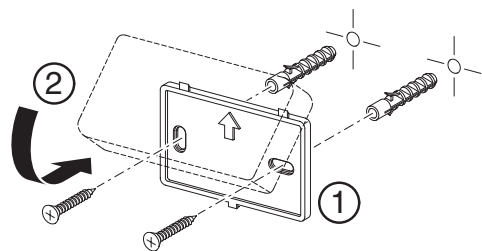

Attach the wall bracket (1) to the wall and click on the thermostat (2).

The thermostat can only control a single heating system component such as a boiler.

8

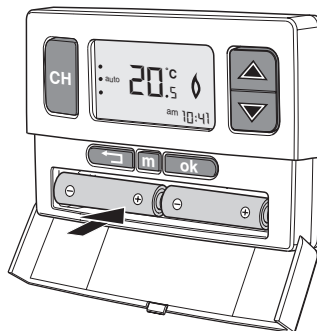

Place the batteries in the room thermostat.

9 Start up

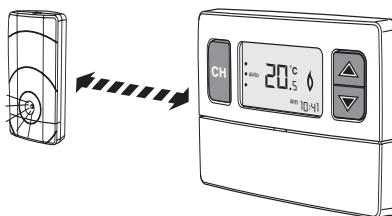

There is no requirement to setup the RF link between the thermostat and receiver. This has been completed as part of the manufacturing process. The room thermostat sends a signal to the receiver at least every 30 minutes to see if they are still in contact with each other. A green LED can be seen on the receiver. If you want to test whether you have reception throughout the house then press the **m** button on the thermostat for more than 5 sec. It will now send out a signal continuously (The LED on the receiver flashes green and the thermostat shows connecting in the display). Walk around the house with the thermostat to check the reception. Maximum signal range is approximately 30 meters. Range may decrease according to building wall construction. Someone will need to stay with the receiver.

The LED on the receiver will turn red (stops flashing) when the thermostat is out of reach. Reposition the receiver if necessary for better reception. The receiver will stay in this test mode for 30 min. or until the **←** button on the thermostat is pressed.

10 Communication loss

When there is a communication loss for longer than 35 minutes, then the LED of the receiver will turn red. What to do:

- Check the batteries (2 x 1.5V - AA - **Alkaline** batteries) of the thermostat and change them if necessary.
- Make sure that the room thermostat is within reach of the receiver.

11 Temporary manual override

It is possible to manually override the thermostat in case of communication loss. To override the thermostat press the button on the receiver.

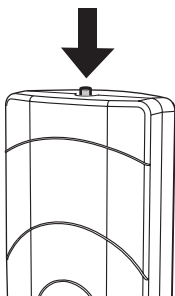

Keep in mind that the boiler will now operate continuously (until the button on the receiver is pressed or until communication has been restored) according to the set flow temperature. Adjust the flow temperature of the boiler if so desired.

The LED will be intermittent red and green.

12 RF link

When one component has been replaced (e.g. receiver), then it is necessary to restore the communication by entering the RF link connecting mode. Make sure that the thermostat is within reach of the receiver.

Press **m** on the thermostat for longer than 5 seconds. The thermostat's display will now show a rotating dash. The receiver LED flashes green. Press the button on the receiver to accept the connecting to the thermostat. The LED on the receiver is now continuously green.

Press the **↩** button on the thermostat to stop the thermostat's connecting mode.

13 Spare Parts

part

wall bracket

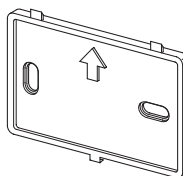

order no.

NE 18212

receiver

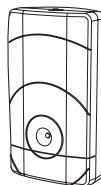

NE 18211

thermostat single

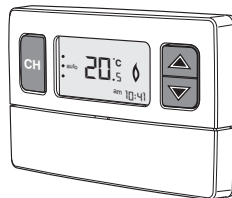

NE 18210

14 Regulations

EC directives:

Low Voltage Directive (73/23/EEC)
 Electro Magnetic Compatibility Directive (89/336/EEC)
 CE Marking Directive (93/68/EEC)

Related Standards:

BS EN607730-1

Buderus

Cotswold Way, Warndon,
 Worcester, WR4 9SW
 Telephone: 01905 - 752 936
 Fax: 01905 - 753 130

Buderus

Customer Services: Tel: 0870 - 421 5933
 Technical Product Support: Tel: 0870 - 421 5944
 Sales: Tel: 01905 - 752 640 Fax: 01905 - 456 445/455 394
 Returns: Tel: 01905 - 752 531 Fax: 01905 - 455 392
 Spares: Tel: 01905 - 752 576 Fax: 01905 - 754 620
www.buderus-domestic.co.uk

**Buderus is a trading name of
 BBT Thermotechnology UK Ltd.**